

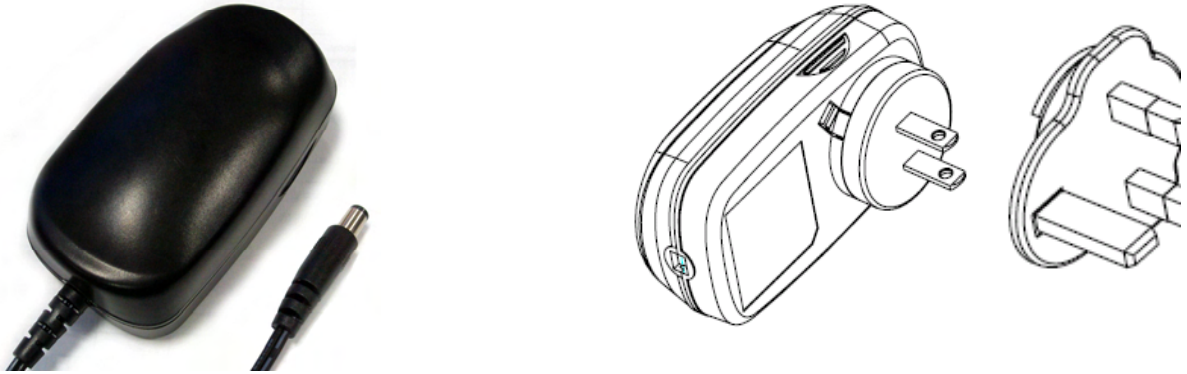

CLICK TECHNOLOGY LIMITED
可立克科技有限公司

24W series



Specification

Input	Output	General
● Input voltage	● Output voltage	● Overcurrent protection
100-240Vac	5-24VDC	Short circuit
● Input frequency	● Output current	● Efficiency
47-63Hz	See following table	>75%
● Input current	● Total output power	● Withstand voltage
0.55Amax.	24Watts max.	3000Vac from input to output&ground
● Inrush current	● Hold up time	● MTBF
30A	5mS at 115Vac input	10000-100000hour
● Stand by loss	● Ripple & noise	● Insulation resistance
<0.5W	%1 Vout	20Mohm min,from input to output &ground.

Model listing

Model configuration

Model No.	Ouput electrical characteristi	
	Voltage(VDC)	Curren(mADC)
CPS024050YYY*	5	4000MAX
CPS024051YYY*	5.1	3920MAX
CPS024052YYY*	5.2	3840MAX

CPS024053YYY*	5.3	3770MAX
CPS024055YYY*	5.5	3630MAX
CPS024056YYY*	5.6	3570MAX
CPS024057YYY*	5.7	3500MAX
CPS024060YYY*	6	3330MAX
CPS024062YYY*	6.2	3220MAX
CPS024063YYY*	6.3	3170MAX
CPS024065YYY*	6.5	3070MAX
CPS024066YYY*	6.6	3030 MAX
CPS024067YYY*	6.7	2980 MAX
CPS024070YYY*	7	2850 MAX
CPS024072YYY*	7.2	2770 MAX
CPS024075YYY*	7.5	3200 MAX
CPS024077YYY*	7.7	3110 MAX
CPS024078YYY*	7.8	3070 MAX
CPS024080YYY*	8	3000 MAX
CPS024083YYY*	8.3	2890 MAX
CPS024084YYY*	8.4	2850 MAX
CPS024085YYY*	8.5	2820 MAX
CPS024087YYY*	8.7	2750MAX
CPS024088YYY*	8.8	2720 MAX
CPS024090YYY*	9	2660 MAX
CPS024092YYY*	9.2	2600 MAX
CPS024093YYY*	9.3	2580 MAX
CPS024095YYY*	9.5	2520 MAX
CPS024096YYY*	9.6	2500 MAX
CPS024097YYY*	9.7	2470 MAX
CPS024100YYY*	10	2400 MAX
CPS024102YYY*	10.2	2350 MAX
CPS024103YYY*	10.3	2330 MAX
CPS024105YYY*	10.5	2280 MAX
CPS024107YYY*	10.7	2240 MAX
CPS024110YYY*	11	2180 MAX
CPS024113YYY*	11.3	2120 MAX
CPS024115YYY*	11.5	2080 MAX
CPS024117YYY*	11.7	2050 MAX
CPS024120YYY*	12	2000 MAX
CPS024123YYY*	12.3	1950 MAX
CPS024125YYY*	12.5	1920 MAX
CPS024126YYY*	12.6	1900 MAX
CPS024127YYY*	12.7	1880 MAX
CPS024130YYY*	13	1840 MAX
CPS024135YYY*	13.5	1770 MAX
CPS024140YYY*	14	1710 MAX
CPS024145YYY*	14.5	1650 MAX

CPS024150YYY*	15	1600 MAX
CPS024155YYY*	15.5	1540 MAX
CPS024160YYY*	16	1500 MAX
CPS024165YYY*	16.5	1450 MAX
CPS024170YYY*	17	1410 MAX
CPS024175YYY*	17.5	1370 MAX
CPS024180YYY*	18	1330 MAX
CPS024185YYY*	18.5	1290 MAX
CPS024187YYY*	18.7	1280 MAX
CPS024190YYY*	19	1260 MAX
CPS024195YYY*	19.5	1230 MAX
CPS024200YYY*	20	1200 MAX
CPS024205YYY*	20.5	1170 MAX
CPS024210YYY*	21	1140 MAX
CPS024215YYY*	21.5	1110 MAX
CPS024220YYY*	22	1090 MAX
CPS024225YYY*	22.5	1060 MAX
CPS024230YYY*	23	1040 MAX
CPS024235YYY*	23.5	1020 MAX
CPS024240YYY*	24	1000 MAX

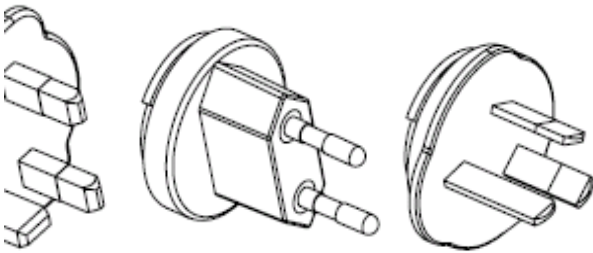

Environmental	Safety&EMC
● Operating temperature	● Safety mark&standards
0-40°C	■ UL/cUL UL60950
● Storage temperature	■ CE EN60950
-20-85°C	■ CB IEC60950
● Cooling mode	■ GS EN60950
free cooling	■ PSE J60950&J55022
	■ BS EN60950
	■ SAA EN60950
	● EMC&EMI standards
	■ FCC part15 class B
	■ CE EN55022 EN61000
	■ AS/NZS CISPR22

ics	
Voltage tolerance	Output power(W)
±5%	20 max.
±5%	19.992 max.
±5%	19.968 max.

±5%	19.981 max.
±5%	19.965 max.
±5%	19.992 max.
±5%	19.95 max.
±5%	19.98 max.
±5%	19.964 max.
±5%	19.971 max.
±5%	19.955 max.
±5%	19.998 max.
±5%	19.966 max.
±5%	19.95 max.
±5%	19.944 max.
±5%	24 max.
±5%	23.947 max.
±5%	23.946 max.
±5%	24 max.
±5%	23.987 max.
±5%	23.94 max.
±5%	23.97 max.
±5%	23.925 max.
±5%	23.936 max.
±5%	23.94 max.
±5%	23.92 max.
±5%	23.994 max.
±5%	23.94 max.
±5%	24 max.
±5%	23.959 max.
±5%	24 max.
±5%	23.97 max.
±5%	23.999 max.
±5%	23.94 max.
±5%	23.968 max.
±5%	23.98 max.
±5%	23.956 max.
±5%	23.92 max.
±5%	23.985 max.
±5%	24 max.
±5%	23.985 max.
±5%	24 max.
±5%	23.94 max.
±5%	23.876 max.
±5%	23.92 max.
±5%	23.895 max.
±5%	23.94 max.
±5%	23.925 max.

±5%	24 max.
±5%	23.87 max.
±5%	24 max.
±5%	23.925 max.
±5%	23.97 max.
±5%	23.975 max.
±5%	23.94 max.
±5%	23.865 max.
±5%	23.936 max.
±5%	23.94 max.
±5%	23.985 max.
±5%	24 max.
±5%	23.985 max.
±5%	23.94 max.
±5%	23.865 max.
±5%	23.98 max.
±5%	23.85 max.
±5%	23.92 max.
±5%	23.97 max.
±5%	24 max.